

Linear Potentiometer 1 or 2 tracks Technology: Hybrid

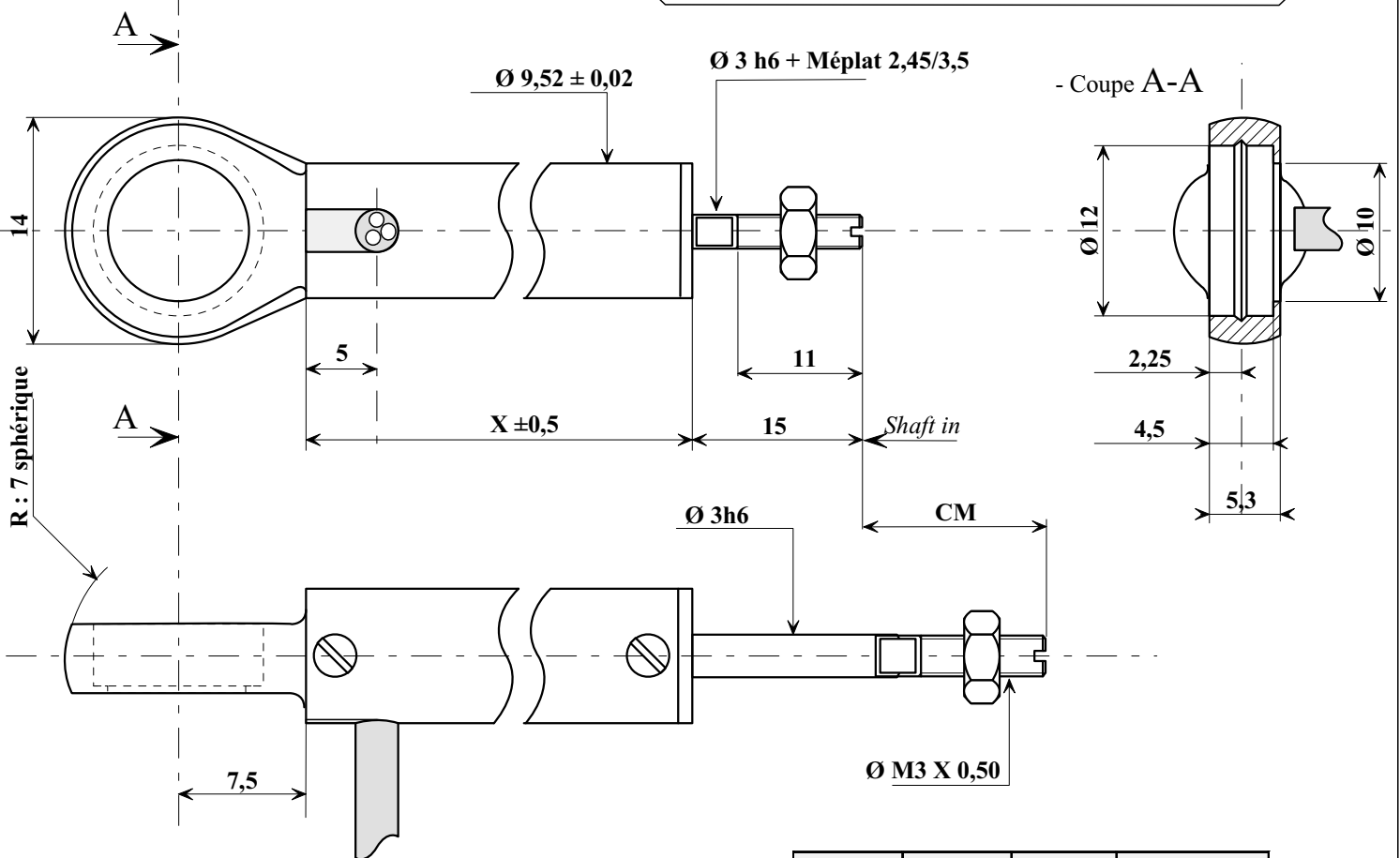

MAIN CHARACTERS

- * Housing in inox steel
- * Shaft in Inox AISI 303
- * 3 or 6 Wire output KZ 05-04 / EF 26-07
length :450 mm
- * Protection DR25 Ø 1/8 on 40 mm
- Mechanical travel : CM
- Electrical travel : CE = CM - 2mm
- Resistance : R : 250 Ω/mm ± 10 %
- Linear fonction
- Linearity < 0,5 %
- Dielectric with standing voltage > 750V/50Hz
- Insulation resistance by 500 Vcc: > 1000 MΩ

Travel CM	Travel CE	Cote X	Resistance
12	10	43	2500
15	13	46	3250
17	15	48	3750
20	18	51	4500
22	20	53	5000
25	23	56	5750
27	25	58	6250
30	28	61	7000
32	30	63	7500
35	33	66	8250
37	35	68	8750
40	38	71	9500
42	40	73	10000
45	43	76	10750
47	45	78	11250
50	48	81	12000
52	50	83	12500
55	53	86	13250

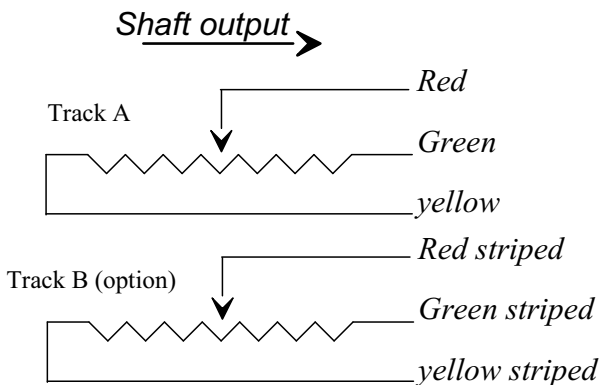

(The red values are standard fabrication)

Linear Potentiometer Ball Body

TOL GEN

EXECUTANT

DATE

ECHELLE

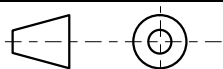

FORMAT

A4



104, Rue de Malcouture
95100 ARGENTEUIL
FRANCE
Tel: 01.39.82.50.04
Fax: 01.39.80.18.71

PLAN SEMIP N°: LPR-FIA

Ind

01